

Mounting Kit 53061-MKPB-QLIV

F250 Super Duty 4x4 1999-2007

F350 Super Duty SRW 4x4 1999-2007

F350 Super Duty DRW 4x4 1999-2007

F450 Super Duty DRW 4x4 1999-2004 - requires also kit #52942-M

F450 Super Duty DRW 4x2 1999-2004 - requires also kit #52942-M

<u>Warning</u>

For the vehicles equipped with BlockerBeam, remove the fasteners on each side from the beam support bracket and remove the beam. Removing the BlockerBeam without installing snow plow attachment hardware may affect air bag deployment in a crash. Do not operate the truck unless either the beam or the snow plow attachment hardware is installed on the vehicle.
--

- Note: For the snowplow lights this kit requires:

800084, 800085 or 800086 Light kit,

53617-M wiring kit and 767052 (vehicle's headlamp H9007) for 1999-2004

800034 adapter (vehicle's headlamp H13) for 2005-2007

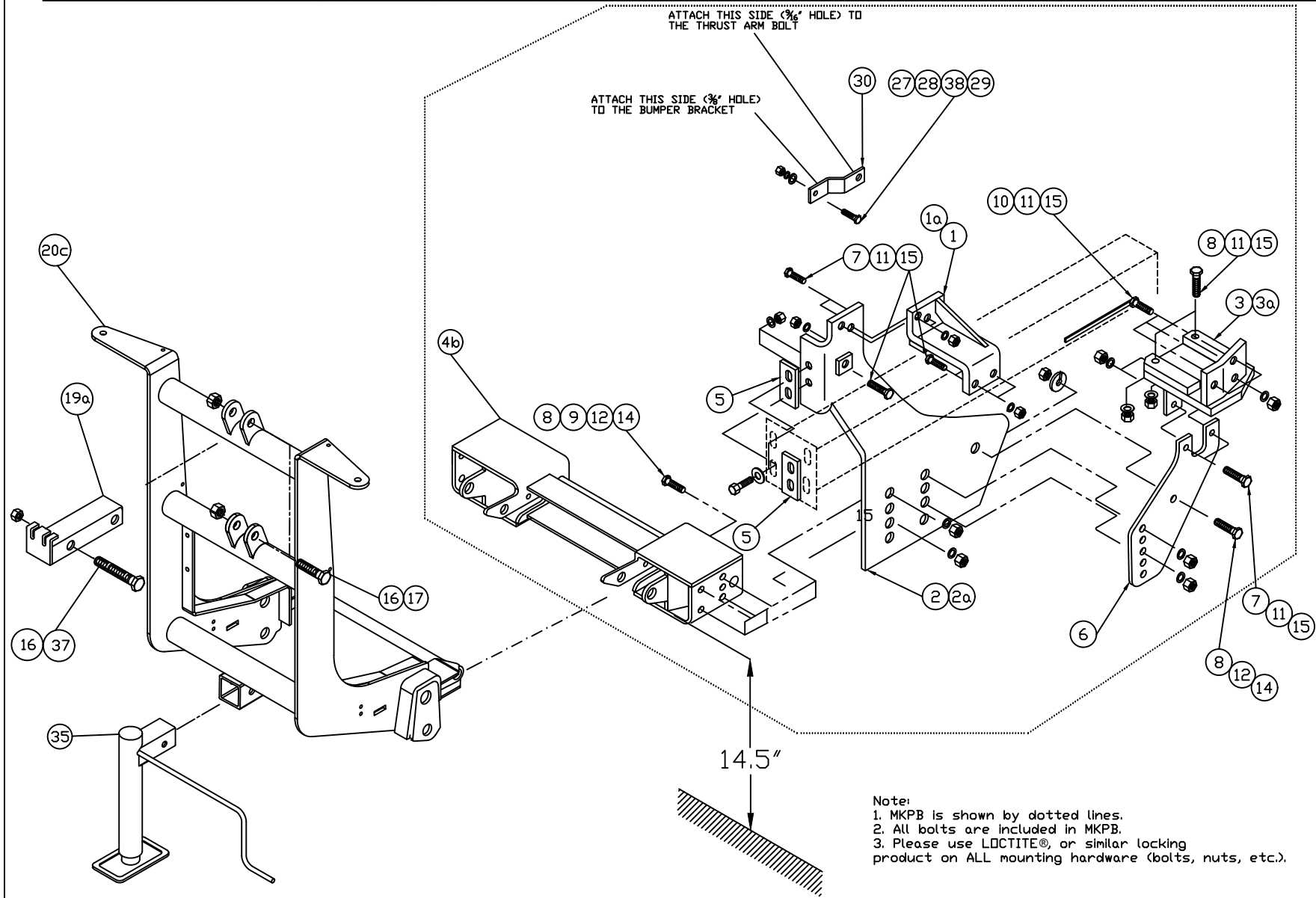

Item	Part #	Description	Quantity
1	52307-01-B	Side Plate Mounting Bracket, driver side	1
1a*	52307-02-B	Side Plate Mounting Bracket, curb side	1
2	52303-01-C	Side Plate, driver side	1
2a*	52303-02-C	Side Plate, curb side	1
3	53062-01-B	Thrust Arm mounting bracket, driver side	1
3a*	53062-02-B	Thrust Arm mounting bracket , curb side	1
4*	52310-D	Spreader Bar	1
4a*	52364-C	Spreader Bar QLII	1
4b	53507-C	Spreader Bar QLIV	1
5	52317-A	Side Plate Spacer	4
6	53064-M	Thrust arm bottom plate	2
7	HH-00972-090	½" UNF x 1.1/2" Cap screw	20
8	HH-00972-129	5/8" UNF x 1.3/4" Cap screw	6
9	HH-00972-131	5/8" UNF x 2.1/4" Cap screw	4
10	52320-A	½" x 1.1/2" Cap screw c/w Welded Handle	6
11	HH-00457-001	½" Lock washer	34
12	HH-00457-003	5/8" Lock washer	10
13	HH-00341-006	½" Flat washer	4
14	HH-00460-001	5/8" UNF Hex nut	10
15	HH-00460-002	½" UNF Hex nut	34
16	HH-00973-007	3/4" UNF Thin Collar Locknut	3
17	HH-00972-153	3/4" x 3.1/2" UNF Cap screw	2
18*	HH-00972-149	3/4" x 2.1/2" UNF Cap screw	1
19*	50069-C-GA	Lift Channel (1 ½" cylinder)	1
19a	52612-B-GA	Lift Channel (2" cylinder)	1
20*	52162-C	Lift Frame	1

Item	Part #	Description	Quantity
20a*	53170-D-GA	Lift Frame, QUIK*LINK ® II- low mount	1
20b*	53171-D-GA	Lift Frame, QUIK*LINK ® II-Hi boy	1
20c	53517-D	Lift Frame, QUIK*LINK ® IV-Hi boy	1
21*	WA-34704-M	Mounting Pin, QLI, Ass'y	2
21a*	52348-M	Mounting Pin Ass'y	2
23*	52208-B-GA	Light Brace	2
24*	52209-B-GA	Light Antler	1
25*	HH-00972-091	½" UNF x 1.3/4" Cap screw	4
26*	HH-00972-092	½" UNF x 2" Cap screw	4
27	HH-00972-029	5/16" UNF x 1 1/4" Cap screw	2
28	HH-00460-005	Nut 5/16"	2
29	HH-00457-007	Lock washer 5/16"	2
30	53065-M	Bumper Bracket	2
31*	HH-00293-006	1/4"x1" UNC Cap screw	4
32*	HH-00341-002	1/4" Flat washer	4
33*	HH-00457-006	1/4" Lock washer	4
34*	HH-00294-001	1/4" Hex Nut	4
35	52373-M	Jack Assembly	1
36*	50999-B	Blade guides	2
37	HH-00972-155	3/4" x 4" UNF Cap screw	2
38	HH-00341-003	5/16" Flat washer	2
39*	53061-M-WB	53061 Bolt bag c/w welded bolts	-

QUIK*LINK is a trademark of Arctic Equipment Manufacturing Corporation

Note: * These items are not shown on the drawing.

GENERAL

Customer must be aware of following:

Arctic Equipment Manufacturing Corporation (Arctic) does not assume liability for damage to your motor vehicle resulting from the attachment or use of an Arctic snowplow. The purchaser assumes all vehicle risk associated with the attachment and operation of this snowplow.

The Arctic snowplow you purchase must be used only on vehicles equipped with the manufacturer's snow plow preparation package. Snow plowing without the original plow preparation package may damage your vehicle. The added weight may impair the operation and control of your vehicle. Snow plowing with a vehicle not recommended for that purpose by the manufacturer may void your new vehicle warranty. If your vehicle is not equipped with an original **snow plow preparation package**, additional equipment may be necessary before snow plowing. Please consult your vehicle and snowplow dealers prior to the purchase and installation of the snowplow. The installation of such parts however is not a full substitute for the original equipment snowplow preparation package.

Caution: Always disconnect the battery cables before beginning the installation.

Before drilling any holes in the firewall or frame, move brake lines, fuel lines and/or electrical wiring from the path of the drill. Brake and fuel lines must also be clear of any fasteners.

All bolts should be installed from the inside of the frame so that the lock washers and nuts are accessible for tightening.

If a slotted hole in the truck frame is utilized, then a flat washer must be used under the bolt head. If a flat washer is used under a lock washer use LOCTITE #242. Also use this LOCTITE #242 if existing (vehicle) bolts and nuts are used.

Do not tighten any bolt assemblies until all fasteners and components are installed, unless otherwise specified.

After first use re-tighten all mounting bolts, thereafter check mounting bolt assemblies periodically.

Before proceeding read instructions carefully and familiarize yourself with the components and hardware.

INSTALLATION INSTRUCTIONS

1. For the vehicles equipped with BlockerBeam™, remove the fasteners on each side from the beam support bracket and remove the beam.
Warning: Removing the BlockerBeam without installing snow plow attachment hardware may affect air bag deployment in a crash. Do not operate the truck unless either the beam or the snow plow attachment hardware is installed on the vehicle.

Detach rubber flap and any electric wires attached to bumper. Remove the bumper fasteners and slide bumper forward to clear tow hooks. Remove and discard the thin plates hanging from the bumper mounts.

2. Insert two ½" x 2" bolts (26) and flat washers (13) through inboard bumper bracket holes from front of vehicle. Slide side plate spacer (5) onto bolts then install side plate (2) (2a) onto bolts (26) and secure with lock washers (11) and hex nuts (15).

NOTE: Be sure that there is sufficient clearance between the drivers' side plate and the power steering cooler lines. If necessary route the lines behind the radiator (unbolt the cooler to gain enough slack in lines to clear edge of radiator then bolt back in original location). The lines must not be pinched or allowed to rub against any other parts.

3. Install side plate mounting brackets (1)(1a) on top of frame rails and fasten to side plates (2)(2a) using two ½" x 1.1/2" bolts (7), lock washers (11) and hex nuts (15).

4. Remove the sway bar from the stabilizer bracket and open the two holes where sway bar was attached to the stabilizer bracket to 9/16". Install the thrust arm frame brackets (3)(3a) and secure to the stabilizer bracket together with the sway bar using ½" x 1.3/4" bolts (8), lock washers (11) and hex nuts (15). Attach the thrust arm bottom plates (6) to the thrust arm frame brackets (3)(3a) using ½" x 1 1/2" bolts (7), lock washers (11) and hex nuts (15) and also to the side plate (2)(2a) rearmost hole using 5/8" x 1 3/4" bolt (8), lock washers (12) and hex nut (14).

5. Insert spreader bar (4b) between side plates (2) (2a) and fasten using 5/8" x 1 3/4" bolts (8), lock washers (12) and hex nuts (14). Use two 5/8" x 2 1/4" bolt (9), lock washer (12) and hex nut (14) in hole that aligns spreader bar (4b), the side plate (2)(2a) and the thrust arm bottom plate (6). The spreader pin hole should be located 14 1/2" (+/- ½") off of the ground.

6. Snug ½" fasteners (7) (11) (15) through stabilizer brackets that hold the thrust arm frame brackets (3)(3a) against bottom of the frame rail. Using three 9/16" holes in the thrust arm frame brackets (3) (3a), one 9/16" hole in side plates (2) (2a) and two 9/16" holes in side plate mounting brackets (1) (1a) as guides, drill 17/32" holes in each frame rail. Insert three ½" x 1 1/2" bolts with handles (10) from inside the frame through the thrust

- arm frame brackets and secure with lock washers (11) and hex nuts (15).
 Insert two 1/2" x 1 1/2" bolts (7) from inside frame through side mounting plates (1) (1a) and secure with lock washers (11) and hex nuts (15).
 Insert one 1/2" x 1 1/2" bolt (7) from inside frame through side plates (2) (2a) and secure with lock washer (11) and hex nut (15).
7. Secure the vehicle bumper to the vehicle frame using the bumper brackets (30). Attach the bumper bracket using 5/16" bolt (27), 5/16" lock washer (28), 5/16" flat washer (38) and 5/16" nut (29) to the bumper (one side) and second side to the bolt on the thrust arm.
 8. Torque all fasteners using torque chart.
 9. Reinstall bumper using spacers (5) with original fasteners. Apply LOCTITE #242 on original fasteners. Reattach any rubber flaps or electric wires removed during bumper removal.
 10. Install lift frame (20c). Slide lift frame (20c) inside of spreader bar (4b).
 11. Torque all fasteners according to torque chart.
 12. Fasten lift channel (19a) and lift cylinder (or power unit) to the lift frame (20c) using 3/4" x 3 1/2" bolts (17) and 3/4" locknut (16). Use 3/4" x 4" bolt (37) and 3/4" locknut (16) to attach lift cylinder to lift channel. NOTE: *Do not over tighten as this assembly must be able to pivot.*
 13. Use 1/4" x 1" bolts, flat washers and hex nuts to fasten blade guides to plow.
 14. See separate installation instructions for the hydraulic power unit, wiring and controls.
 15. Torque all fasteners using torque chart.

Torque Chart (Ft. Lb)		
Size	Grade 5 Bolt	Grade 8 Bolt
1/4 - 28	8	11
5/16 - 24	15	22
3/8 - 24	28	40
7/16- 20	44	63
1/2- 20	69	97
5/8- 18	138	195
3/4-16	241	341
Note: Torque values are for plated bolts only.		

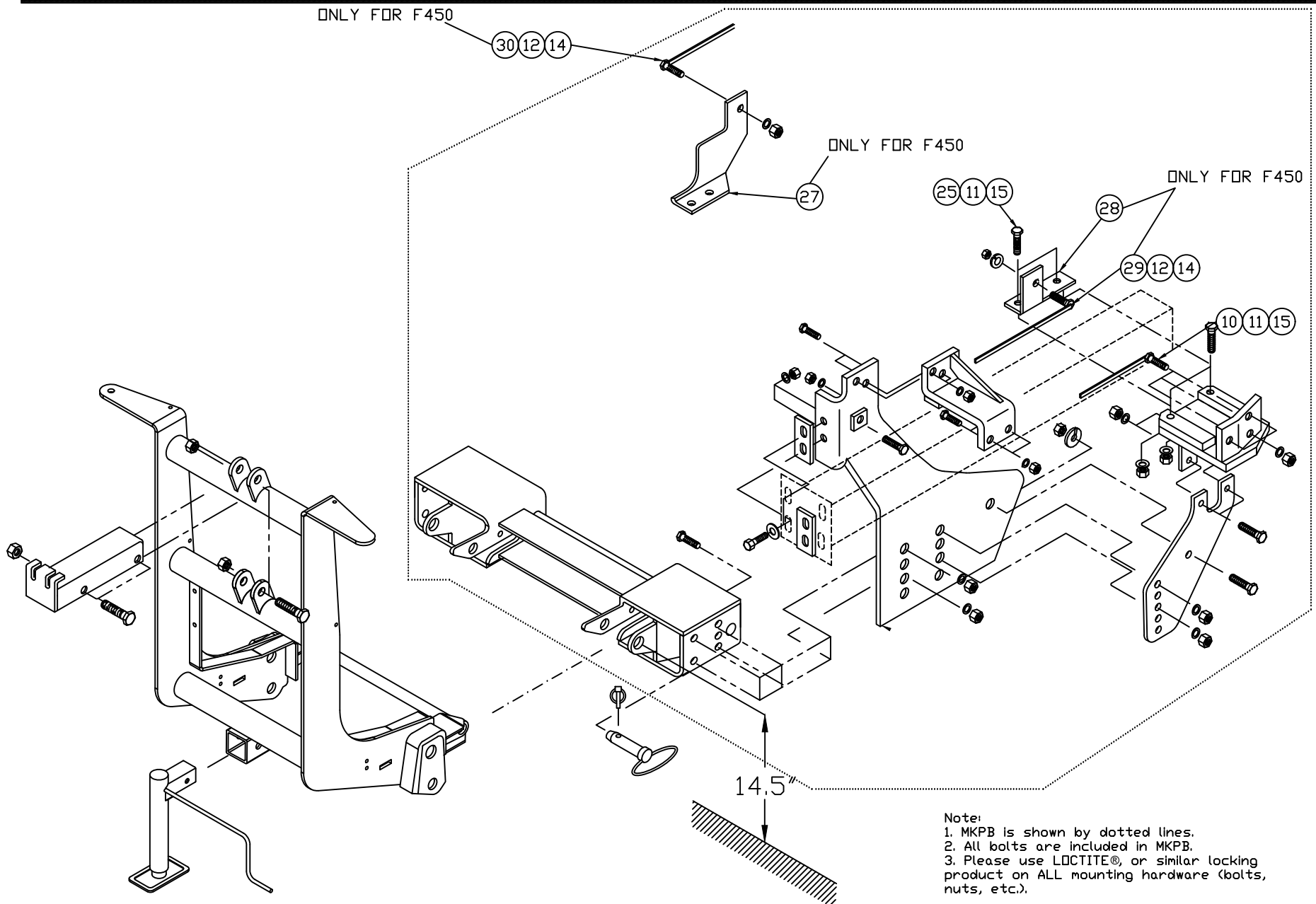

Adapter Kit 52942-M required for F450 Super Duty								
Item	Part #	Description	MKP B	MKP B- QLII	QL- MK B	QLII- MKB	QLII- HI- MKB	QLII- HI- MKB- TE
12	HH-00457-003	5/8" Lockwasher	2					
14	HH-00460-001	5/8" UNF Hexnut	2					
27	52516-04-B	Support Angle, Curb Side	1					
28	52515-03-A	Support Angle, Driver Side	1					
29	52575-03-A	5/8" x 1.1/2" Cap screw c/w Welded Handle 14"	1					
30	52575-01-A	5/8" x 1.1/2" Cap screw c/w Welded Handle 6"	1					

INSTALLATION INSTRUCTIONS FOR 52942-M

1. Follow instruction from installation sheet 53061-MKPB.
2. For thrust arm installation, install support angle (27)(28) on inside of the vehicle frame, using 5/8" welded bolt (29)(30), 5/8" nut (14) and 5/8" lock washer (12).
3. Install thrust arms between springs and bottom of frame rail from outside of frame by feeding the bottom of the thrust arm through first. The chassis may have to be raised slightly to permit installation. Secure thrust arm to support angle (27)(28) using 1/2" x 1.3/4" bolts (25), lock washers (11) and hex nuts (15).
4. Continue installation using 53061-MKPB